

## WARRANTY INFORMATION

1. Trident Communication Technology warrants that your product will be free from defects in material and workmanship for two years from the date of purchase. If, during the first year from the date of purchase, your product fails to work due to a defect in material workmanship, Trident Communication Technology will repair or replace the product, at its election, free of charge. Without proof of purchase, the warranty period begins on the date of manufacture. Consumable components (for example, cushions) are not included in this two-year warranty.

2. The forgoing limited warranty does not cover equipment failure attributable to accident, improper operation, misuse, abuse, or any cause other than defects in the materials or workmanship of Trident Communication Products.

For the complete Trident Communication Technology, LLC. hardware product warranty statement, visit: <http://www.tridentcomtech.com/warranty>

If you have problem using your equipment in contact Trident Customer Support at [customer.support@tridentcomtech.com](mailto:customer.support@tridentcomtech.com)

For the latest version of this User Manual visit: <http://www.tridentcomtech.com/manuals>

## QUICK PAIRING INSTRUCTIONS

1. From "Off State" Initiate Standard Bluetooth pairing by pressing the MFB for 6 seconds - press and hold the button until you hear "**Pairing, please wait**" and the LED alternately flashes red and blue.
2. Use the device's Bluetooth search and pairing functionality and select "**MC1-EcoPro**". If necessary, enter four zeros (0000) for the passcode and accept connection.
3. For Touch-to-Pair, initiate Standard Bluetooth pairing, then touch the headset NFC tag to the NFC tag of host. The headset NFC Tag is in the Microphone Assembly.

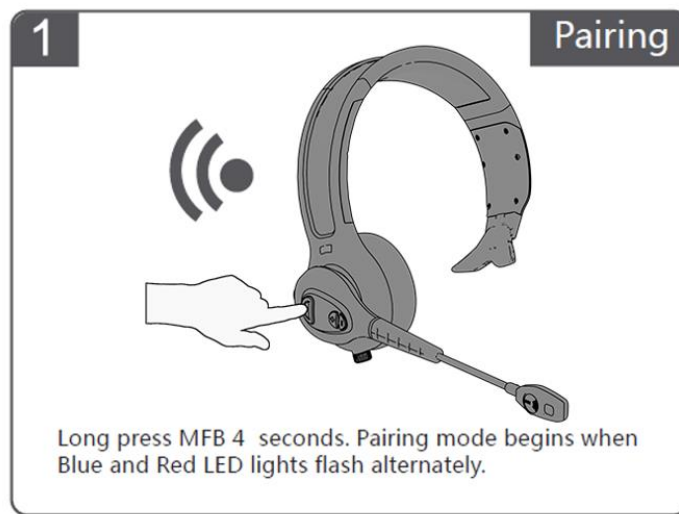

## Download the App



Monitor your light exposure live in the app. The charging screen on the app will let you know if your headset is receiving great charging or poor charging depending on the light exposure.

**More Light. More Power**

**MC1-EcoPro™**  
**IS ALWAYS CHARGING.**

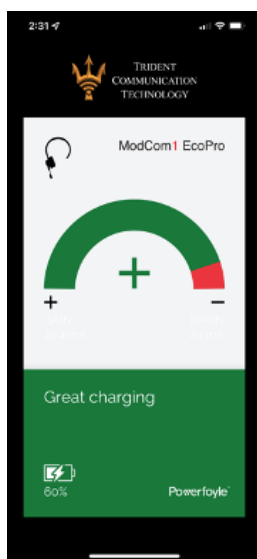

## MC1-EcoPro™ Quick Start Guide

### Adjust Flexband and T-Bar for Perfect Fit

Headband is adjustable in top half (highlighted in yellow)

1. Flex Highlighted Area to Widen or Tighten.
2. Adjust T-Bar.

